

ETC Setup Guide

Source Four® LED CYC Floor Base

Overview

The Source Four LED CYC Floor Base allows adjustable floor mounting of the CYC fixture. No tools are needed for base setup.

Set up the Floor Base

- 1: Ensure that the yoke of the CYC fixture is in its longest (standard) setting.



- 2: Lift the fixture cradle from the base and pivot it until it comes in contact with the stop-tabs.

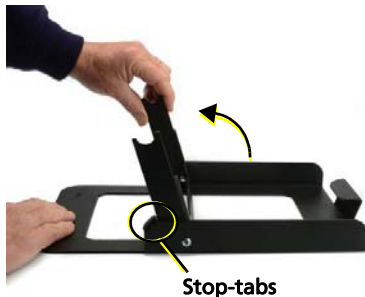

- 3: Position the fixture yoke under the rear retaining tab.



- 4: Rest the fixture's locking knobs in the cradle of both cradle arms.



- 5: Adjust the fixture angle as needed using the T-handle locking knobs.



Corporate Headquarters ■ Middleton, WI, USA ■ Tel +608 831 4116 ■ Service: (Americas) service@etcconnect.com

London, UK ■ Tel +44 (0)20 8896 1000 ■ Service: (UK) service@etcurope.com

Rome, IT ■ Tel +39 (06) 32 111 683 ■ Service: (UK) service@etcurope.com

Holzkirchen, DE ■ Tel +49 (80 24) 47 00-0 ■ Service: (DE) techserv-hoki@etcconnect.com

Hong Kong ■ Tel +852 2799 1220 ■ Service: (Asia) service@etcasia.com

Web: etcconnect.com ■ © 2017 Electronic Theatre Controls, Inc.

Product information and specifications subject to change. ETC intends this document to be provided in its entirety.

7460M2200 ■ Rev B ■ Released 2017-07